

Product Overview

This rack mount kit (RM6051) is designed to mount RIGOL MHO/DHO5000 series digital oscilloscope, MHO2000 series digital oscilloscope, DS9000 series digital oscilloscope, DG5000 Pro series function/arbitrary waveform generator, DG6000 series function/arbitrary waveform generator, DNA5000 series vector network analyzer, and RSA6000 series real-time spectrum analyzer into a 19-inch cabinet that conforms to the Electronic Industries Association (EIA) standard.

Note: Keep the air intake areas of the MHO/DHO5000 series digital oscilloscope, MHO2000 series digital oscilloscope, DS9000 series digital oscilloscope, DG5000 Pro series function/arbitrary waveform generator, DG6000 series function/arbitrary waveform generator, DNA5000 series vector network analyzer, and RSA6000 series real-time spectrum analyzer far away from heat sources.

Part Checklist

No.	Name	Qty.	Description
1	M6 Screw	4	M6x16 Phillips Pan Head Screw
2	Handle	2	10x128 Rack Handle
3	M4 Screw	14	M4x6 Torx Pan Head Screw
4	Rack Front Panel	1	6U Rack Front Panel
5	M6 Nut	4	M6 Square Lock Cage Nut
6	Left Rack Bracket	1	6U Left Rack Bracket
7	Right Rack Bracket	1	6U Right Rack Bracket

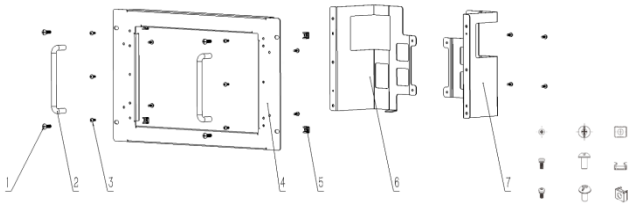

RM6051 Rack Mount Kit Part List

- Use four M4x6 torx pan head screws to fasten the two handles to the rack front panel.

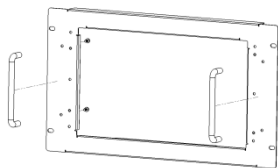

- Use four M4x6 torx pan head screws to fasten the left and right rack brackets to the instrument.

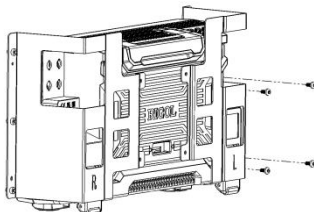

- Use six M4x6 torx pan head screws to fasten the pre-assembled brackets (from Step 2) to the pre-assembled front panel (from Step 1).

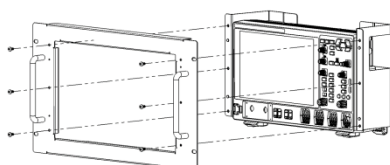

Installation Tool

The PH2 Phillips screwdriver and T20 torx screwdriver are recommended.

Space Requirements

To mount the instrument into the cabinet correctly, please ensure that the following requirements are met.

- The cabinet must be a standard 19-inch one.
- The available height of the cabinet should be at least 6U (266.7 mm).
- The depth of the cabinet should be at least 200 mm.

The dimensions of the rack are as shown below.

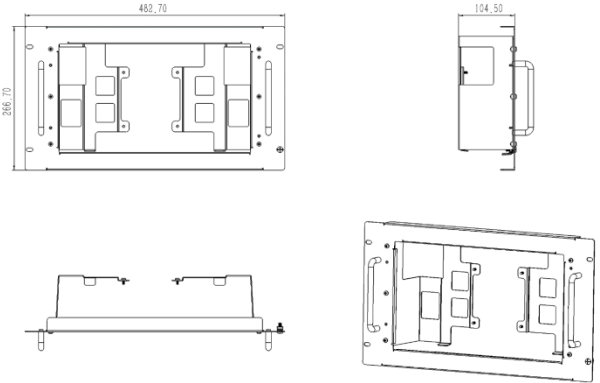

Unit: mm

Installation Procedures



CAUTION

Only authorized operators are allowed to perform the installation. Improper installation might cause damage to the instrument or an installation failure.

- Mount the assembled instrument and rack into a standard 19-inch cabinet by using four M6x16 phillips pan head screws.

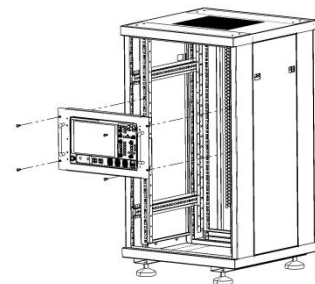

- The following figure shows the successful rack mount installation for one instrument.

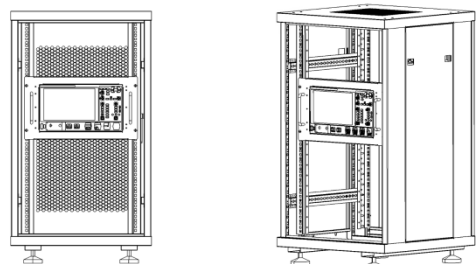

-End-